

## BADE Pipe regulator gates



### BADE Pipe regulator gates

Full welded regulating gates to regulate, open, or close a ducting line in an installation (possibility to regulate).

The gate blade is locked in a desired position by thightening the butterfly nut on the handle.

These gates are suitable for the transport of waste materials such as dust and chips but also for the transport of grains and such.

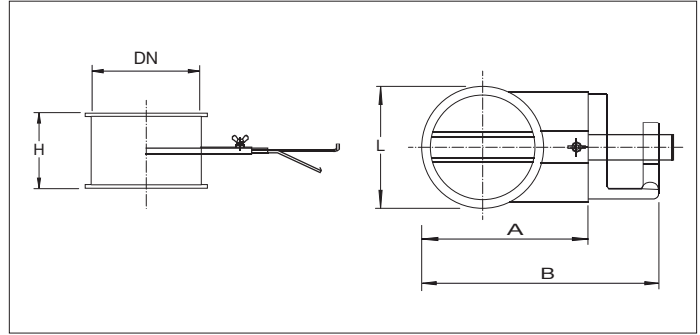

### Material

2.00 mm black steel 1.0330 powder coated in RAL 7032.

Electrostatically conductive and food-safe powder coating thickness of 30 to 60 µm.

Temperature resistance up to +80°C.

### Type

Rolled sheets with 6 mm edges for lock rings.

### Options

- FDA and EU compliant food-grade quality
- stainless steel execution
- wear resistant lining as of Ø150 (83° Shore)
- equipotential equalization
- other colors
- other types of edges or connections



Butterfly nut to lock the blade in the desired position

Ø d mm	Code	A mm	B mm	L mm	H mm	s mm	Weight kg
100	BADE000001	150	245	115	70	2.00	1.10
120	BADE000002	190	285	135	70	2.00	1.60
150	BADE000003	235	330	165	70	2.00	2.28
175	BADE000004	270	365	190	70	2.00	2.75
200	BADE000005	310	405	215	70	2.00	3.63
250	BADE000006	385	480	265	70	2.00	5.10
300	BADE000007	460	555	315	70	2.00	3.80