

BADB Manual sliding dampers

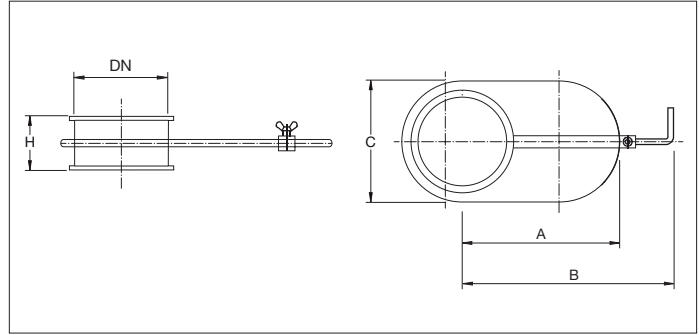

BADB Manual sliding dampers

Full welded manual sliding dampers to regulate, open, or close a ducting line in an installation (possibility to regulate).

The sliding damper blade is locked in a desired position by tightening the butterfly nut on the handle.

Not suitable for applications with bulk material.

Material

1.50 or 2.00 mm black steel 1.0330 powder coated in RAL 7032. Electrostatically conductive and food-safe powder coating thickness of 30 to 60 µm. Temperature resistance up to +80°C.

Type

Rolled sheets with 6 mm edges for lock rings.

Options

- FDA and EU compliant food-grade quality
- electro-galvanized or stainless steel execution
- wear resistant lining as of Ø150 (83° Shore)
- equipotential equalization
- other colors
- other types of edges or connections

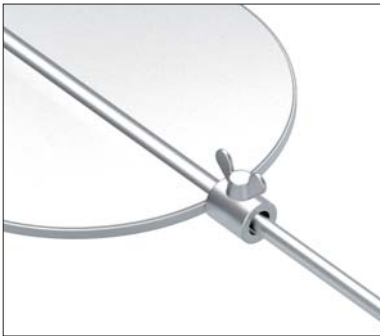

Butterfly nut to lock the blade in the desired position

Ø d mm	Code	A mm	B mm	C mm	H mm	s mm	Weight kg
100	BADB000002	245	340	135	58	1.50	0.94
120	BADB000003	285	380	155	58	1.50	1.30
140	BADB000004	345	440	185	70	1.50	2.05
150	BADB000005	345	440	185	70	1.50	2.20
160	BADB000006	400	495	210	70	1.50	2.35
175	BADB000007	400	495	210	70	1.50	2.55
200	BADB000008	455	550	235	70	1.50	3.62
224	BADB000009	555	650	285	70	1.50	4.05
250	BADB000010	555	650	285	70	1.50	4.60
280	BADB000011	655	750	335	100	1.50	5.15
300	BADB000012	655	750	335	100	1.50	7.90
315	BADB000013	755	850	385	100	1.50	8.30
350	BADB000014	755	850	385	100	2.00	10.64
400	BADB000015	855	950	435	100	2.00	12.11
450	BADB000016	955	1050	485	100	2.00	16.60
500	BADB000017	1055	1150	535	100	2.00	23.00
550	BADB000018	1155	1250	585	100	2.00	25.30
560	BADB000019	1195	1290	595	100	2.00	25.76
600	BADB000020	1255	1350	635	100	2.00	27.60
630	BADB000021	1335	1430	665	100	2.00	28.98