

## BADR Electric silo outlet gates



### BADR Electric silo outlet gates

Full welded electric silo outlet gates to discharge material from a cyclone, a silo, or such.

The outlet gate blade is secured in an open or closed position by means of the electric worm gear drive motor 0.18 kW, 230/400 V AC 50/60 Hz foreseen with limit switches.

Suitable for applications with bulk and granular material with a relative humidity of 15% but not for installations in overpressure or pneumatic transport.

The gate must be installed horizontally.

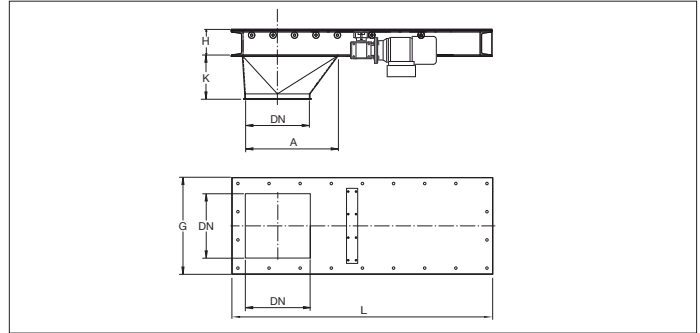

### Material

2.00 mm black steel 1.0330 powder coated in RAL 7032.

Base frame 5.00 mm black steel 1.0330 powder coated in RAL 7032.

Electrostatically conductive and food-safe powder coating thickness of 30 to 60 µm.

Temperature resistance up to +80°C.

### Type

Welded and folded plates with or without 6 mm edges for lock rings.

### Options

- FDA and EU compliant food-grade quality
- with seal
- left and right hand versions
- hot-dipped galvanized or stainless steel execution
- wear resistant lining as of Ø150 (83° Shore)
- equipotential equalization or ATEX
- other colors
- other types of edges or connections

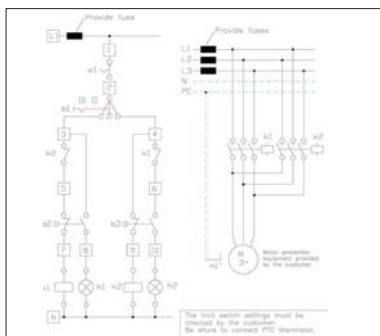

**⚠ Please specify LEFT or RIGHT orientation when ordering**

Wiring diagram of worm gear drive

\* Weights are models with transition piece

Ø d mm	Code		A mm	G mm	H mm	K mm	L mm	s mm	Weight kg*
	w. transition	w/o. transition							
150	BADR000001	BADR000010	226	300	126	175	850	2.00	49.00
175	BADR000002	BADR000011	251	325	126	175	850	2.00	54.00
200	BADR000003	BADR000012	276	350	126	175	950	2.00	58.00
250	BADR000004	BADR000013	326	400	126	224	1050	2.00	66.00
300	BADR000005	BADR000014	376	450	126	206	1080	2.00	72.00