

BZZ Caps for inspection branches



BZZ Caps for inspection branches

Rubber caps for inspection branches that insure airtightness of the opening. They can also be used as an end cap in an installation.

These can be fitted with a cap lock to ensure that rubber cap stays in place (especially used in overpressure installations).

These caps are suitable for the transport of waste materials such as dust and chips but also for the transport of grains and such.

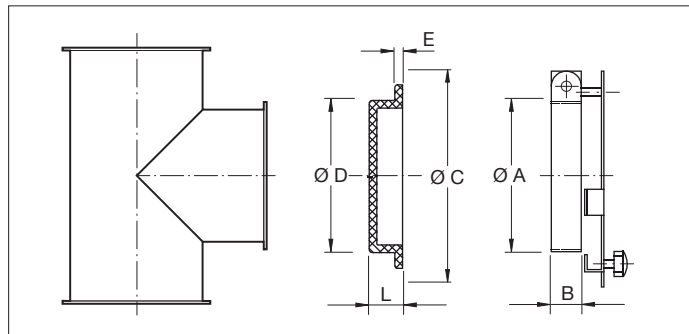

Material

TPE rubber (black) or food-safe TPE rubber (white).
Working temperature range : -50°C to +100°C.
Lock in untreated AISI 304.

Type

Preformed TPE rubber with edge.

Options

- none

Caps

Ø d mm	TPE black	Code	TPE white	Ø C mm	Ø D mm	E mm	L mm	Weight kg
100	BZZS000002		BZZS000010	122	101	5	22	0.13
120	BZZS000003		BZZS000011	140	121	6	24	0.21
150	BZZS000004		BZZS000012	176	151	7	33	0.32
175	BZZS000005		BZZS000013	205	176	7	35	0.47
200	BZZS000006		BZZS000014	228	201	8	40	0.58
250	BZZS000007		BZZS000015	280	251	10	42	0.80
300	BZZS000008		BZZS000016	328	301	8	40	1.30

Locks

Ø d mm	Code	Ø A mm	Ø B mm	Weight kg
100	BBZG000002	80	20	0.27
120	BBZG000003	100	20	0.33
150	BBZG000004	120	20	0.43