

BDGB Jet caps

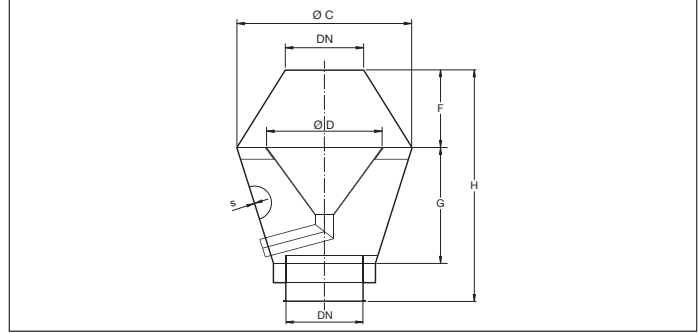

BDGB Jet caps

Fully welded jet cap with a sheet thickness of 2.00 mm equipped with an inner cone and drain for rain water.

Serves the same purpose as rain caps for air expulsion through a roof.

The advantage compared to a rain cap is that the air is accelerated before being expelled which means that finer particles are sent higher into the air.

Material

2.00 mm hot-dipped galvanized sheet metal.
Temperature resistance up to +80°C.
Galvanization according to DIN 1461 with a thickness of 65 µm.

Type

Rolled sheets with 6 mm edges for lock rings.
With welded Reihe II T2 flange as of Ø350.

Options

- FDA and EU compliant food-grade quality
- stainless steel execution
- equipotential equalization
- other types of edges or connections

* with welded Reihe II (T2) flange

Ø d mm	Code	Ø C mm	Ø D mm	F mm	G mm	H mm	s mm	Weight kg
100	BDGB000002	203	150	100	150	300	2.00	3.40
120	BDGB000003	303	250	150	250	450	2.00	5.20
140	BDGB000004	353	250	150	250	450	2.00	5.79
150	BDGB000005	353	250	150	250	450	2.00	6.20
160	BDGB000006	353	250	150	250	450	2.00	8.69
175	BDGB000007	403	300	200	350	600	2.00	9.50
200	BDGB000008	453	300	200	350	600	2.00	15.00
224	BDGB000009	453	300	200	350	600	2.00	16.13
250	BDGB000010	503	350	200	350	600	2.00	18.00
280	BDGB000011	553	350	250	350	700	2.00	17.27
300	BDGB000012	553	400	250	400	700	2.00	18.50
315	BDGB000013	553	400	250	400	700	2.00	22.95
350*	BDGB000014	653	500	280	500	830	2.00	25.50
400*	BDGB000015	703	500	300	550	900	2.00	29.50
450*	BDGB000016	803	550	340	600	990	2.00	46.80
500*	BDGB000017	853	600	360	650	1060	2.00	53.50
550*	BDGB000018	953	700	400	700	1150	2.00	68.00
560*	BDGB000019	953	700	400	700	1150	2.00	84.00
600*	BDGB000020	1053	750	450	750	1250	2.00	90.00
630*	BDGB000021	1103	800	500	800	1350	2.00	94.50