

RSEP - Rotating separator

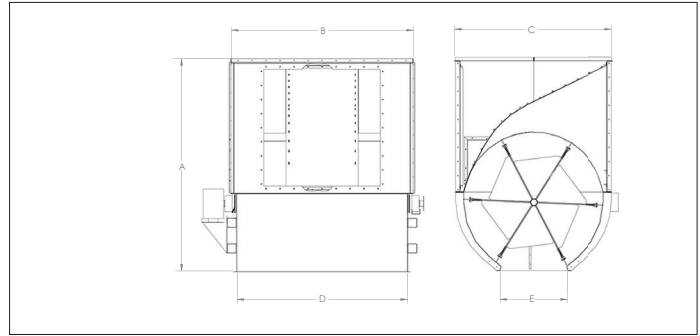
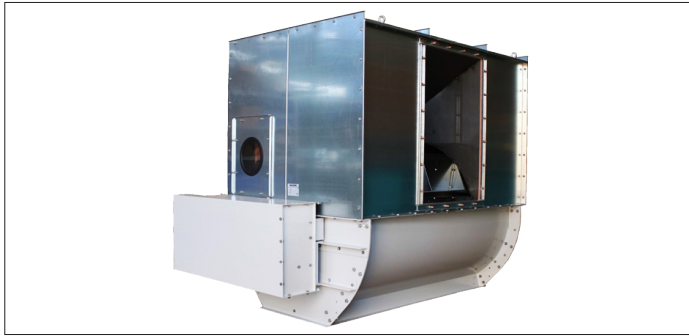

RSEP rotating separator

The rotational separator replaces with success the big volume cyclones, or static separators in the paper and cardboard industry.

The coarse material is extracted to the separator and discharged pressureless to either a baler or a compactor. That results in an improved working environment because the dust is removed.

The design of the separator consists of a large diameter rotary feeder, coupled with a specially perforated plate designed to withstand intensive operation.

The separator comprises of a 6 blades rotor, equipped with wear resistant rubber that rotates slowly. This equipment has been designed to operate in demanding and intensive conditions and should not exceed 70 dB(A) at a distance of 1 meter when correctly installed.

Air volumes : from 8000 to 60000 m³/h
Max pressure : from 2500 up to 6.000 Pa

These separators are produced according to the following harmonized directives/standards :

- 2006/42/EC ; Machine directive
- 2014/35/EC ; Low voltage directive
- 2014/30/EC ; Electromagnetic compatibility directive

Material

St 37.2 - 2 mm black steel plate Surface powder enamelled RAL 5010 structure and rubber blades.

Type

2 mm plates welded together

Options

- Stainless steel perforated grill (AISI 304)
- Weatherproof roof for exterior installation

Advantages

- High reliability
- Efficient separation
- Low pressure loss and pressureless separation
- Reduced plant operating cost
- Improved working environment
- Compact unit with large separation capacity



Sturdy construction

Construction is made to last and is weather resistant.

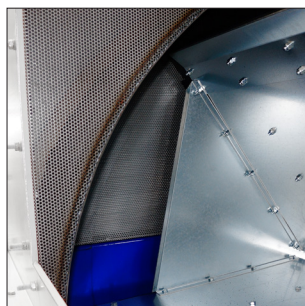

Inner grill

Inner grill on all side of the upper part for best airflow.

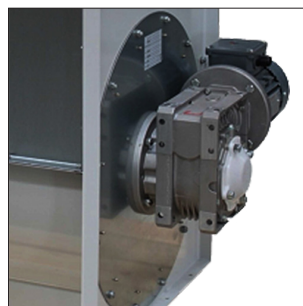

Easy replacements

Rubber blades can easily be replaced on some models.



Inspection door

Integrated inspection doors on both side to monitor proper functioning.

RSEP - Rotating separator

Model	Volume (m ³ /h)	Volume ¹⁾ (kg/h)	Power (kW)	Motor Rotation (rpm)	Gear reduction	Rotor rotation (rpm)	Max. pressure (Pa)	Max temp. (°C)
RSEP1-ST	8000	750	0.75	1500	1/64	22.5	2500	70
RSEP2-ST	22000	2200	1.5	1500	1/33	14	2500	70
RSEP2-HP	22000	2200	1.5	1500	1/33	14	6000	70
RSEP3-ST	35000	3500	2.2	1500	1/33	15	2500	70
RSEP3-HP	35000	3500	2.2	1500	1/33	15	6000	70
RSEP4-ST	50000	5000	3.0	1500	1/160	9.1	2500	70
RSEP4-HP	50000	5000	3.0	1500	1/160	9.1	6000	70
RSEP5-ST	60000	6000	3.0	1500	1/33	15	2500	70
RSEP5-HP	60000	6000	3.0	1500	1/33	15	6000	70

¹⁾ Volume output at 100% degree of filling

Dimensions :

Model	A (mm)	B (mm)	C (mm)	D (mm)	E (mm)	Air IN (mm)	Air OUT (mm)	# of blades	Weight (kg)
RSEP1-ST	1000	985	670	925	385	500 x 250	500 x 500	6	200
RSEP2-ST	1690	925	1250	925	600	900 x 350	900 x 700	6	480
RSEP2-HP	1690	925	1250	925	600	900 x 350	900 x 700	6	550
RSEP3-ST	1690	1525	1190	2050	600	900 x 600	900 x 1200	6	700
RSEP3-HP	1690	1525	1190	2050	600	900 x 600	900 x 1200	6	1000
RSEP4-ST	2360	1595	1733	2185	798	1250 x 700	1250 x 1250	6	1500
RSEP4-HP	2360	1595	1733	2185	798	1250 x 700	1250 x 1250	6	1800
RSEP5-ST	2353	1895	1733	1895	798	1250 x 1550	1250 x 1550	6	2000
RSEP5-HP	2353	1895	1733	1895	798	1250 x 1550	1250 x 1550	6	2400

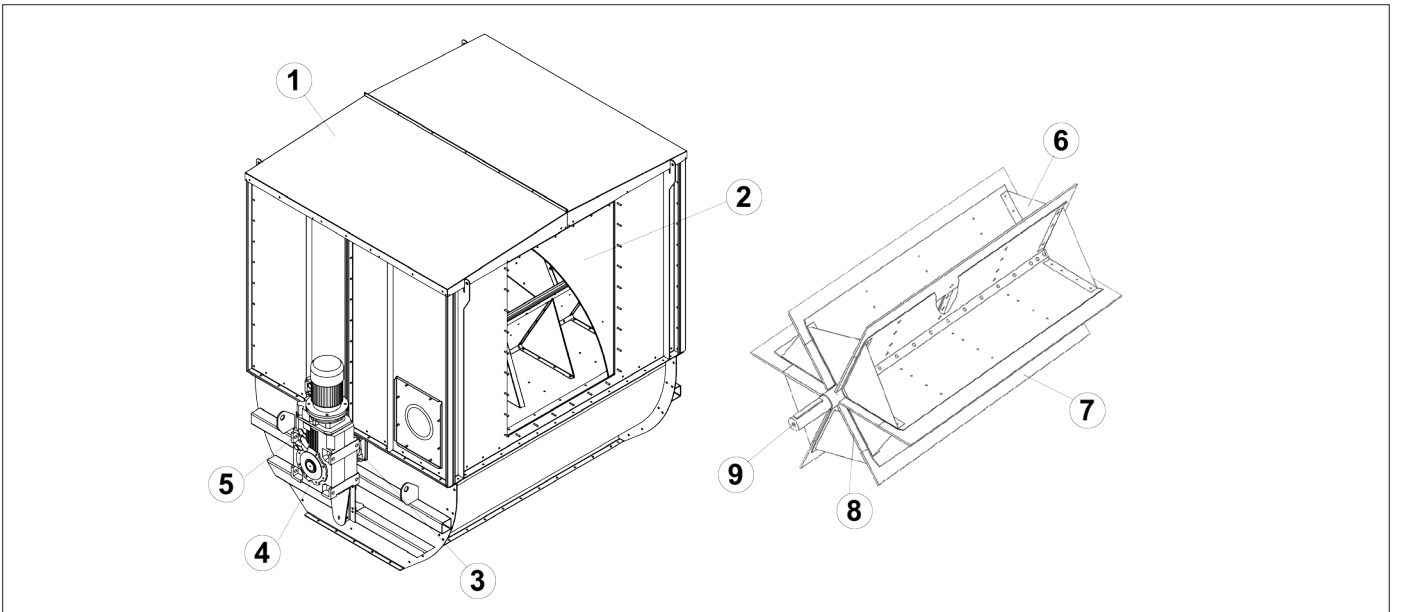

Spare parts list for rotating separator type RSEP

Please only use original spare parts to guarantee a worry free functioning of the rotating separator.

#	Part	Description
1	Separator housing	Upper part galvanized, lower part powder coated steel
2	Perforated grill	Galvanized sheet metal
3	Bearings	Flanged bearing for axle
4	Worm gear	Worm gear for B5 motor
5	Motor	B5 electric motor, IP 55
6	Rotor	Galvanized sheet metal
7	Rubber blade	Horizontal rubber blade, 1 per vane
8	Rubber blade	Vertical rubber blade, 2 per vane
9	Axle	Steel axle with shaft key