

**BABA Bends R=2D 60°**

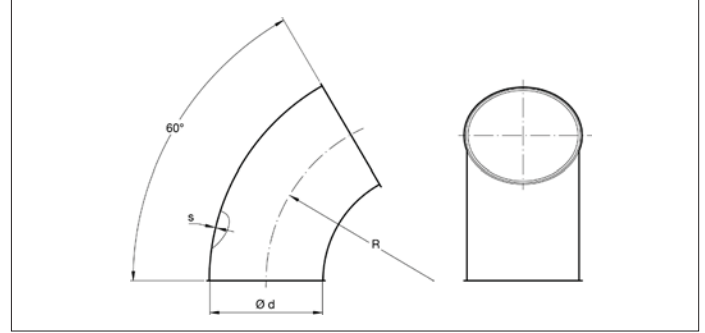

**BABA Bends R=2D - 60°**

The pressed bends are made of two preformed halves and longitudinally fully welded together with a sheet thickness of 2.00 mm.

The segmented bends are made of welded segments fully welded together.

These bends are suitable for the transport of waste materials such as dust and chips but also for the transport of grains and such.

They are only available in R=2D. If a situation requires other radiuses, these can be done in segmented versions.

**Material**

2.00 mm black steel 1.0330 powder coated in RAL 7032. Electrostatically conductive and food-safe powder coating thickness of 30 to 60 µm. Temperature resistance up to +80°C.

**Type**

Pressed or rolled sheets with 6 mm edges for lock rings.

**Options**

- FDA and EU compliant food-grade quality
- hot-dipped galvanized or stainless steel execution
- wear resistant lining as of Ø150 (83° Shore), only on segmented models
- equipotential equalization
- other colors
- other diameters
- other sheet thickness, depending on radius and diameter
- other types of edges or connections

\* Segmented models

Ø d mm	Code	R mm	# of segments	s mm	Weight kg
100	BABA000136	200	1	2.00	1.05
120	BABA000137	240	1	2.00	1.52
140*	BABA000138	280	5	2.00	2.06
150	BABA000139	300	1	2.00	2.37
160*	BABA000140	320	5	2.00	2.70
175	BABA000141	350	1	2.00	3.22
200	BABA000142	400	1	2.00	4.21
224	BABA000143	448	1	2.00	5.28
250	BABA000144	500	1	2.00	6.58
280*	BABA000145	560	5	2.00	8.25
300	BABA000146	600	1	2.00	9.47
315*	BABA000147	630	5	2.00	10.45
350*	BABA000148	700	5	2.00	12.90
400*	BABA000149	800	5	2.00	16.84
450*	BABA000150	900	5	2.00	21.32
500*	BABA000151	1000	5	2.00	26.32
550*	BABA000152	1100	5	2.00	31.85
560*	BABA000153	1120	5	2.00	33.01
600*	BABA000154	1200	5	2.00	37.90
630*	BABA000155	1260	5	2.00	41.78