

BACF Inspection branches at 90°



BACF Inspection branches at 90°

Full welded cylindrical inspection branches at 90° with a sheet thickness of 2.00 mm. The side opening can be closed off with the TPE rubber caps on the next page (BZZS & BZZT).

These Inspection branches are suitable for the transport of waste materials such as dust and chips but also for the transport of grains and such.

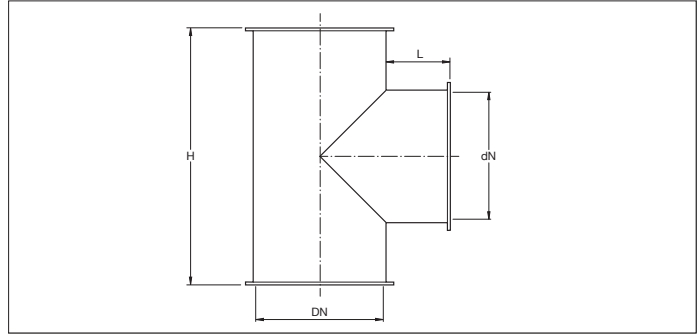

Material

2.00 mm black steel 1.0330 powder coated in RAL 7032.

Electrostatically conductive and food-safe powder coating thickness of 30 to 60 µm.

Temperature resistance up to +80°C.

Type

Rolled sheets with 6 mm edges for lock rings.

Options

- FDA and EU compliant food-grade quality
- hot-dipped galvanized or stainless steel execution
- wear resistant lining as of Ø150 (83° Shore)
- equipotential equalization
- other colors
- other diameters
- 3 mm sheet thickness, depending on length and diameter
- other types of edges or connections

| Ø d mm | Code | dN mm | H mm | L mm | s mm | Weight kg |
|-----------|------------|----------|---------|---------|---------|--------------|
| 100 | BACF000010 | 80 | 30 | 150 | 2.00 | 1.01 |
| 120 | BACF000011 | 100 | 33 | 170 | 2.00 | 1.21 |
| 150 | BACF000012 | 100 | 33 | 170 | 2.00 | 1.73 |
| 175 | BACF000013 | 120 | 33 | 200 | 2.00 | 2.29 |
| 200 | BACF000014 | 150 | 35 | 230 | 2.00 | 2.61 |
| 250 | BACF000015 | 150 | 35 | 230 | 2.00 | 3.27 |
| 300 | BACF000016 | 150 | 35 | 230 | 2.00 | 3.92 |
| 350 | BACF000017 | 150 | 35 | 230 | 2.00 | 4.57 |