

CZBA Flexible bends

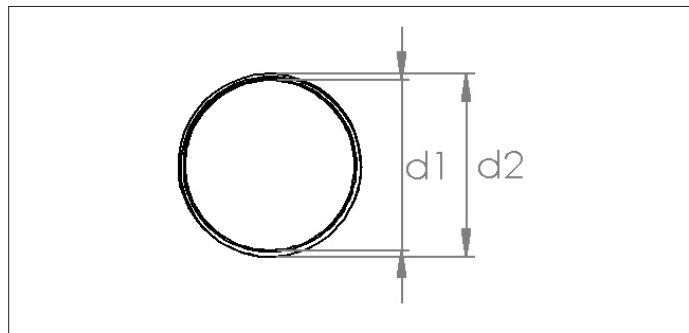

CZBA Flexible bends

Universal flexible bends for the suction of dusts, chips, metal particles, gases, etc., in the wood industries, furniture manufacturing, mechanical and metallurgic industries and other industries.

These are held in place on the ductwork by means of the GADB hose clamps (see Connecting components).

! The exterior diameter is measured from the top of the corrugations.

Advantages

- Light and very flexible.
- Excellent bend radius.
- Recommended when low weight and easy handling are valued.

Technical characteristics

- Inner tube: wear resistant SBR/NR, black, smooth.
- Reinforcement: synthetic textile with embedded steel helix.
- Outer coating: wear and weather resistant SBR/NR, black, corrugated.
- Temperature range: -40°C to +90°C.
- Electrical properties: conductive tube and outer coating, $R < 10^6 \Omega/\text{cm}$.

Options

- HD version (High density), identical as above but thicker.

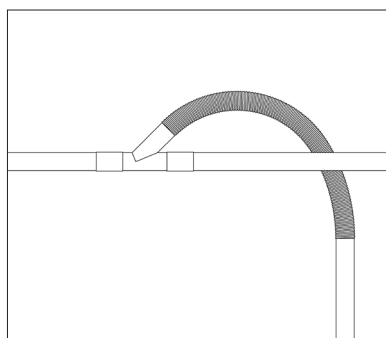

Example of bend installed in ductwork

Ø d	Code	d1 Ø mm	d2 Ø mm	Max. bend radius mm	Max. underpressure bar	Weight kg
51	CZBA000001	50	56	70	0.90	0.63
63	CZBA000002	63	68	95	0.90	0.72
76	CZBA000003	76	81	115	0.90	0.86
102	CZBA000004	102	108	145	0.90	1.32
127	CZBA000005	127	134	170	0.70	1.63
152	CZBA000006	152	159	195	0.40	1.94
203	CZBA000007	203	211	245	0.15	3.06