

BABA Bends R=2D 30°

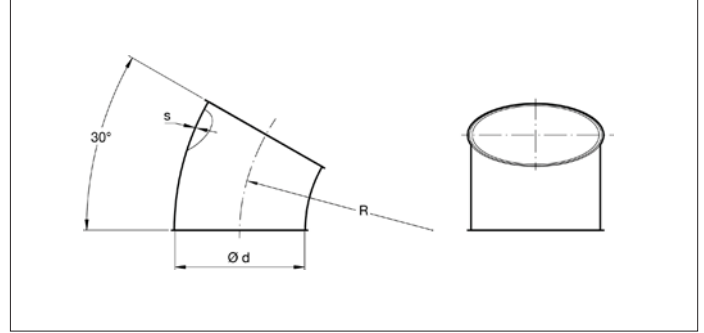

BABA Bends R=2D - 30°

The pressed bends are made of two preformed halves and longitudinally fully welded together with a sheet thickness of 2.00 mm.

The segmented bends are made of welded segments fully welded together.

These bends are suitable for the transport of waste materials such as dust and chips but also for the transport of grains and such.

They are only available in R=2D. If a situation requires other radiuses, these can be done in segmented versions.

Material

2.00 mm black steel 1.0330 powder coated in RAL 7032. Electrostatically conductive and food-safe powder coating thickness of 30 to 60 µm. Temperature resistance up to +80°C.

Type

Pressed or rolled sheets with 6 mm edges for lock rings.

Options

- FDA and EU compliant food-grade quality
- hot-dipped galvanized or stainless steel execution
- wear resistant lining as of Ø150 (83° Shore), only on segmented models
- equipotential equalization
- other colors
- other diameters
- other sheet thickness, depending on radius and diameter
- other types of edges or connections

* Segmented models

Ø d mm	Code	R mm	# of segments	s mm	Weight kg
100	BABA000022	200	1	2.00	0.53
120	BABA000023	240	1	2.00	0.76
140*	BABA000024	280	3	2.00	1.03
150	BABA000025	300	1	2.00	1.18
160*	BABA000026	320	3	2.00	1.35
175	BABA000027	350	1	2.00	1.61
200	BABA000028	400	1	2.00	2.11
224	BABA000029	448	1	2.00	2.64
250	BABA000030	500	1	2.00	3.29
280*	BABA000031	560	3	2.00	4.13
300	BABA000032	600	1	2.00	4.74
315*	BABA000033	630	3	2.00	5.22
350*	BABA000034	700	3	2.00	6.45
400*	BABA000035	800	3	2.00	8.42
450*	BABA000036	900	3	2.00	10.66
500*	BABA000037	1000	3	2.00	13.16
550*	BABA000038	1100	3	2.00	15.92
560*	BABA000039	1120	3	2.00	16.51
600*	BABA000040	1200	3	2.00	18.95
630*	BABA000041	1260	3	2.00	20.89