

Roof passages

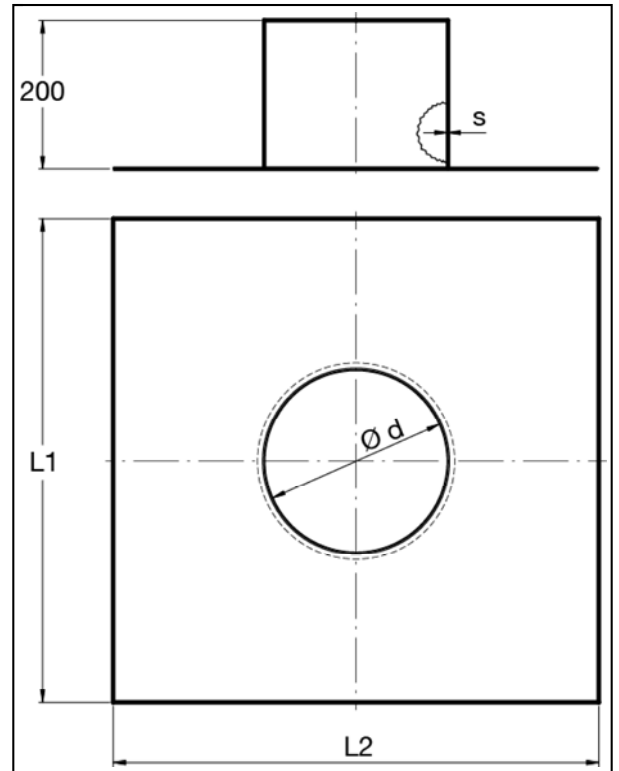

Roof passages AWT

Roof passages are standard longitudinally welded with a stitch-welder and spot-welded on a flat plate.

They are designed to be used with ducting with edges. It might be necessary to switch to a bigger diameter if ducting with flanges is used.

Material

Sendzimir galvanized.

Type

Rolled and cut sheets stitch-welded and spot-welded.

Options

- Other diameters, e.g. for rectangular ducting
- Other sheet thickness
- Other versions, for example at an angle for a pitched roof (specify slope when ordering)

! With the use of flanges on the ducting a bigger diameter for roof passage is needed.

Ø mm	code	Ø d mm	L1 mm	L2 mm	s mm
80	AWT080	105	480	480	0.88
100	AWT100	125	500	500	0.88
120	AWT120	145	520	520	0.88
140	AWT140	165	540	540	0.88
150	AWT150	175	550	550	0.88
160	AWT160	185	560	560	0.88
180	AWT180	205	580	580	0.88
200	AWT200	225	600	600	0.88
220	AWT220	245	620	620	0.88
225	AWT225	250	625	625	0.88
250	AWT250	275	650	650	0.88
275	AWT275	300	675	675	0.88
280	AWT280	305	680	680	0.88
300	AWT300	325	700	700	0.88
315	AWT315	340	715	715	0.88
350	AWT350	375	750	750	0.88
355	AWT355	380	755	755	0.88
400	AWT400	425	800	800	0.88
450	AWT450	475	850	850	0.88
500	AWT500	525	900	900	0.88
550	AWT550	575	950	950	0.88
560	AWT560	585	960	960	0.88
600	AWT600	625	1000	1000	0.88
630	AWT630	655	1030	1030	0.88
650	AWT650	675	1050	1050	0.88
700	AWT700	725	1100	1100	0.88
710	AWT710	735	1110	1110	0.88
750	AWT750	775	1150	1150	0.88
800	AWT800	825	1200	1200	0.88
850	AWT850	875	1250	1250	0.88
900	AWT900	925	1300	1300	0.88
950	AWT950	975	1350	1350	0.88
1000	AWTM10	1025	1400	1400	0.88