

## Powder coated welding ends

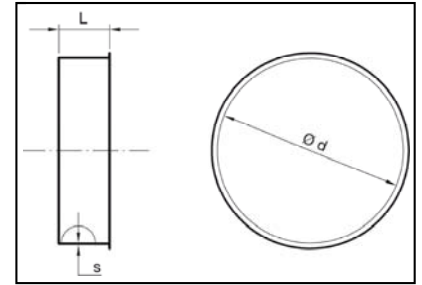

### Powder coated welding ends BCW

The welding ends are used at the start of a ducting system; for example on machinery, filter installations, screw conveyors, etc.

### Material

Black steel.

### Type

With a 8 mm edge for all types of lock rings.

### Options

- Diameters > Ø 600 mm
- Sheet thickness up to 3 mm, depending on diameter
- Painted version (RAL 7032)

Ø mm	Code	Ø d mm	L mm	s mm	Weight kg
80	BCW080	77	55	2.00	0.15
100	BCW100	99	55	2.00	0.20
120	BCW120	119	55	2.00	0.31
125	BCW125	124	55	2.00	0.35
140	BCW140	139	55	2.00	0.40
150	BCW150	149	55	2.00	0.45
160	BCW160	159	55	2.00	0.50
180	BCW180	179	55	2.00	0.55
200	BCW200	199	55	2.00	0.61
220	BCW220	219	55	2.00	0.65
225	BCW225	224	55	2.00	0.67
250	BCW250	249	55	2.00	0.76
275	BCW275	274	55	2.00	0.80
280	BCW280	279	55	2.00	0.85
300	BCW300	299	55	2.00	0.91
315	BCW315	314	55	2.00	0.95
350	BCW350	349	55	2.00	1.01
355	BCW355	354	55	2.00	1.02
400	BCW400	398	55	2.00	1.21
450	BCW450	448	55	2.00	1.30
500	BCW500	498	55	2.00	1.52
550	BCW550	549	55	2.00	1.67
560	BCW560	558	55	2.00	1.69
600	BCW600	598	55	2.00	1.76
630	BCW630	628	55	2.00	1.90